

Once again...

Well, time, as always, flies like wind and it is once more the time for the Original Courthouse Annual Meeting; a chance for our members to elect themselves and others to a position on the Board of Directors, to approve changes and improvements on the day to day goings on at the museum, set policy and all the things that keep this old courthouse rolling along. This year's meeting will be at the Courthouse Museum on May 31st at 1:00 pm, so leave your calendar open...

And, as always we sweeten the pot by adding a program with a bit of local history for your enjoyment.

We received a grant from The Oregon Cultural Trust to help with some informational signage about the historic Zimmerman shed out behind the museum.

With a kick start from that grant money we hope to open up the building for our visitors, and, as a

beginning we will present a combined program at the meeting to explore the Zimmerman story, the preservation of the building and the exhibit potential.

(to learn a bit more, see the story on page 2.)

A Word From Your President

Hi All,

Welcome to spring! It was a busy winter, with the highlight being the annual Original Courthouse Regional History Forum. As always, the presentations were fascinating and well attended and well received. This Forum is our main yearly event, and it was great to see old and new friends alike brought together in the Courthouse. Thank you to everyone who made this all work for our 46th year!

The Original Courthouse was the recipient of a grant from the Wasco Cultural Trust. The grant will help fund the interpretation of a new exhibit at the Courthouse, the restored Zimmerman Shed. The Zimmerman family and the Shed will also be the subject of our Annual Meeting. You can find more about both the shed and the meeting elsewhere in this fine publication. As always, there are plenty of opportunities for interested folks to help out with things at the Courthouse, ranging from continued restoration and maintenance, help with landscaping and grounds, and service on the board.

If you are interested, please give me a call at (503) 505-4121.

Thanks,

-Eric Gleason, President



Eric receiving the grant check from The Oregon Cultural Trust

MISSION STATEMENT

It is the mission of the Original Wasco County Courthouse Preservation Corporation to preserve the Original Wasco County Courthouse; to collect, exhibit and interpret items related to the governmental/legal history of Wasco County; to provide a venue for presentations of local historical interest; and preserve and make available educational & research materials.

News On The Zimmerman Shed

Perhaps you may never have noticed the small outbuilding in the back, southeastern corner of the museum property. Its unassuming exterior belies its value to our local history. It started life as a multipurpose outbuilding of the original private residence on the property. From a time when every home had a collection of these sorts of buildings on the back of their property, they kept the weather away from your buggy and assorted tack, the stacked and dried winter fuel supply, outdoor tools and the root cellar... not to mention your bare backside while you did that most basic of daily rituals. And since this property owner was also a professional carpenter, it served as his woodworking shop. There was no fanfare (and therefore no record) when it was built but it does show up on the 1888 Sanborn fire map. Early maps explain its sprawl across the property line since Mr Zimmerman, the owner of the home at 410W. 2nd Place, owned the property east all the way to Pentland Street. Putting his carpentry skills to good use he also erected the home east of the museum now labeled The Historic Zimmerman House.

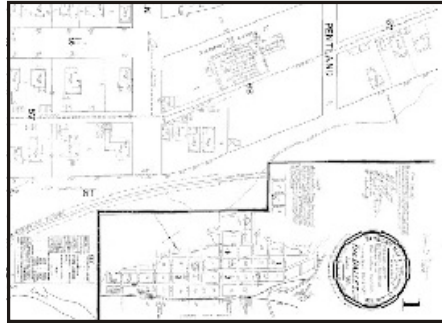

And now, 130 plus years later, this small building is one of very few of its kind still standing and is one of the oldest buildings in The Dalles and needs to be preserved for the future. In pursuit of this goal the deeds and history of the building has been undertaken, an archeological survey was done to look for artifacts from its use and non-profit group called the Preservation Action League was formed in the late 1990s to rehabilitate and stabilize the building.

And now, with help from our partnership with The Oregon Cultural Trust, we want to open the building to our visitors and expand the reasons to drop in. Since the building had many uses over the years we had a variety of possibilities to chose from. It was felt that its time as a carpenter shop might have a broader visitor base than, oh say, a root cellar (*"Hey look Martha, taters..."*)

This idea was helped along in no small part by the presence of the original carpenter's workbench along eleven feet of one wall. Fill in around this centerpiece with an array of smaller tools and such and you'll have an informative look at what it was like to be a woodwright in the early days here in The Dalles... *"ow, my thumb..."*

Plans Are Afloat Once Again...



There is a new cruise ship line that is replacing the now defunct American Empress Cruise Line who ran our Hop On Hop Off visitor bus tours. We met with Sarah Gray and Anna Gaffney from the American Cruise Lines a few weeks ago, who want to be our contact people for their shore tours. We gave them a ten cent tour of the Courthouse, locked 'em in the jail and discussed some very rudimentary plans and ideas in regards to re-establishing us on their tour schedule. Since we made a number of improvements to resolve visitor concerns and it has been a boon to our numbers over the years., this can only be a plus for the museum's future. Nothing has been decided but we hope to hear back soon.

Please help sustain history in The Dalles by supporting the Original Wasco County Courthouse and our partner organizations.

*Original Wasco County Courthouse
Fort Dalles Museum & Anderson Homestead
Wasco County Historical Society
The Rorick/Moody House
The Wing Hong Hai Building
St. Peter's Landmark
The Neon Sign Museum
The Veterans' Museum in City Hall
The Granada Theater
The Dalles Mural Society
District 21 School Museum
The Dalles Fire Museum
Columbia Gorge Discovery Center & Museum
Wasco County Pioneers
The Dalles Civic Auditorium*

Our Esteemed Board of Directors
& hangers on various and sundry



Eric Gleason: *President,*
vacant: Vice President,
Rodger Nichols: *Secretary,*
Sheila Dooley: *Treasurer*
sitting Board members:
Sandy Bisset,
Karl Vercouteren,
Sherry Mumford,
Carol Stace,
and Linda Wilson
with

Trish Neal: *Internet support,*
Duane Powell: *Technical support,*
Chris Bolton: *Newsletter Editor & Docent,*

HOURS AND ADMISSION FEES

Thursday, Friday and Saturday
MAY 1st through SEPTEMBER 27th
11:00am -3:00 pm

Extended hours for group visits
by previous appointment

Adults	\$4.00 each
Family Rate	\$8.00
Youth 12-18	\$3.00 each
Children 6-11	\$2.00 each
Children under 6	FREE
Adult Groups	\$3.00 each
Youth Groups 6-17	\$2.00 each

And as always, remember that if you are current on this year's Museum membership you always get in for free!

The Original Wasco County Courthouse is an Oregon Cultural Trust Partner. As a contributor to our organization you are eligible to participate in Oregon's Cultural Trust Tax Credit program. Donors who contribute to Oregon's cultural non-profits, including the Original Wasco County Courthouse, are eligible to make matching donations to The Oregon Cultural Trust and receive 100% tax credit for the Trust Donation (up to \$500 for individual, \$1000 for a couple filing jointly and \$2,500 for a Class-C Corporation).

Learn more at culturaltrust.org



Thank You For Your Support

We need your e-mail address! No, we promise not to sell it to anyone. But once we have it, we can send you the newest newsletter *in full, postage free, color...* and with a few easy keystrokes you will be able to send it on to friends. Those of you without e-mail, please don't worry. We will continue to send the same information to you by snail mail. (Remember our membership year runs from January 1st through December 31st each year.) You can print this page separately, in black and white, and get yourself this snazzy membership application to fill out and mail in... And there is a second membership form just right for passing along to that friend you want to become a member too! Asking a friend to join with you helps us exceed last year's membership numbers, and filling in your e-mail address on your membership form is the easiest way to place yourself on the list to receive the full color newsletter, thereby saving yourself from a drab life in black and white...

Please take a minute and renew your membership and continue being a vital part of our historic preservation effort.



ORIGINAL COURTHOUSE PRESERVATION CORPORATION MEMBERSHIP APPLICATION

The Original Courthouse Preservation Corp. is a Federally designated 501(C)3 non-profit organization.
As such your donations & membership dues are tax deductible to the extent allowable by law.

(PLEASE PRINT)

NAME: _____ DATE: _____

MAILING ADDRESS: _____

CITY: _____ STATE: _____ ZIP: _____

PHONE: _____ EMAIL: _____

MEMBERSHIP LEVEL
Please check appropriate box

Please mail this form and your check to:
Original Courthouse Preservation Corp.
PO Box 839 The Dalles, OR 97058

\$15.00 Individual \$25.00 Family \$40.00 Sustaining \$100.00 Patron

Additional donation _____ Donation in memory of: _____ in honor of: _____



ORIGINAL COURTHOUSE PRESERVATION CORPORATION MEMBERSHIP APPLICATION

The Original Courthouse Preservation Corp. is a Federally designated 501(C)3 non-profit organization.
As such your donations & membership dues are tax deductible to the extent allowable by law.

(PLEASE PRINT)

NAME: _____ DATE: _____

MAILING ADDRESS: _____

CITY: _____ STATE: _____ ZIP: _____

PHONE: _____ EMAIL: _____

MEMBERSHIP LEVEL
Please check appropriate box

Please mail this form and your check to:
Original Courthouse Preservation Corp.
PO Box 839 The Dalles, OR 97058

\$15.00 Individual \$25.00 Family \$40.00 Sustaining \$100.00 Patron

Additional donation _____ Donation in memory of: _____ in honor of: _____

